

### PRG

shown with cut-away

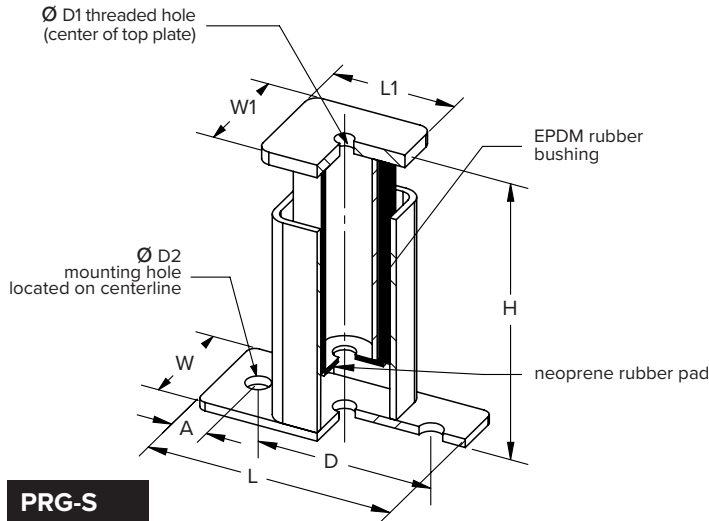

### PRG-S

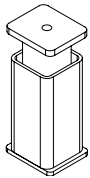

### PRG

standard initial height configurations

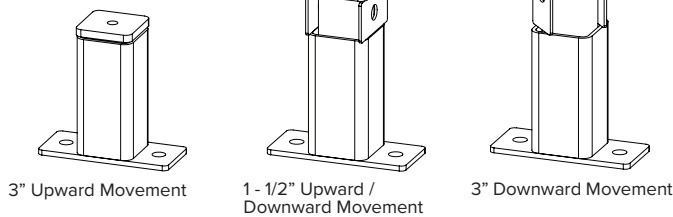

### MOUNTING DIMENSIONS

Model	Ø D2 Mounting Hole		D		W		A	
	in	mm	in	mm	in	mm	in	mm
PRG-25	1 1/16	18	5	127	3	76	1	25
PRG-38	1 3/16	21	6 1/4	159	3 1/2	89	1 1/8	29

### NOTES

- This product comes in different configurations:
  - PRG (Pipe Riser Vertical Sliding Guides with base plate for attachment to both concrete and steel).
  - PRG-S (Pipe Riser Vertical Sliding Guides for welded attachment to steel).
- Sliding guides are part of an engineered support system for pipe risers that expand or contract due to changes in temperature—typically between initial installation and operation.
- Sliding guides are always used in pairs. They are used to control radial motion while axial motion is guided.
- Each pair of PRG vertical sliding guides minimizes noise and vibration transmission by using EPDM heavy duty rubber bushings between telescoping components.
- Welded steel construction provided with black oxide or painted finish.
- Each PRG guide comes complete with spacers to help in positioning the telescoping portion at one of the standard initial heights. See the installation instructions for more information.

### INSTALLATION HEIGHT (H)

Model	3" Upward Movement (min.)		1 1/2" Up or Down Movement		3" Downward Movement (max.)	
	in	mm	in	mm	in	mm
PRG-25	6 3/4	175	8 1/2	216	10	254
PRG-38	7	178	8 3/4	222	10 1/4	260

### DIMENSIONS

Model	Lateral Capacity Per Pair**		L		L1		W1		BPT		TPT		Ø D1 - UNC tapped	Weight per Guide		
	lbs	KN	in	mm	in	mm	in	mm	in	mm	in	mm		lbs	kg	
PRG-25	2900	12.9	7	178	3 1/2	89	3	76	1/4	6	3/8	10	5/8	16	8.2	3.72
PRG-S-25	2900	12.9	3 1/2	89	3 1/2	89	3	76	1/4	6	3/8	10	5/8	16	8.2	3.72
PRG-38	5300	23.6	7 1/2	89	4 1/2	114	3 1/2	89	3/8	13	1/2	13	3/4	19	10.5	4.76
PRG-S-38	5300	23.6	3 1/2	191	4 1/2	114	3 1/2	89	3/8	13	1/2	13	3/4	19	10.5	4.76

\*\*Lateral capacity is shown for a pair of guides fully welded to structure. Attachment to structure typically controls lateral capacity of guides.

Project:			Model:			QTY of Pairs Required:		
Customer:			Tag:					
Consultant:			Comments:					
Dwg No.:	Rev:	Drawn by:						
V-A Project Manager:								