

tel: 416-291-7371 1-800-565-8401
fax: 416-291-8049 1-888-811-2264

web: www.vibro-acoustics.com
eml: info@vibro-acoustics.com

SPG Spider Pipe Guide
Installation Instructions

File No.: INS-SPG-001
Supersedes: New

Date: 2 Jan 2015
Date: New

INSTRUCTIONS

- Guides should be positioned at recommended spacing. 'D' is the pipe O.D.

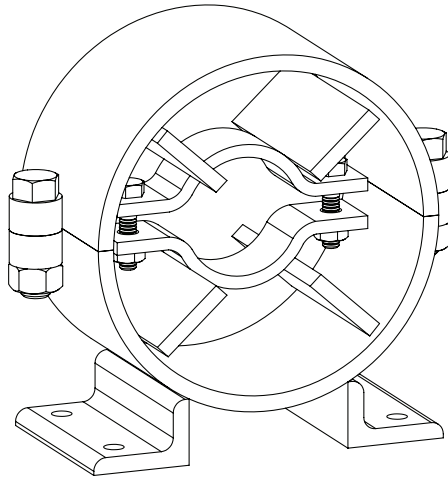
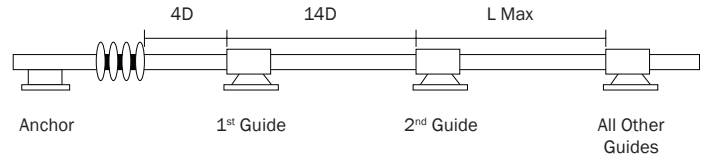

Pipe Size	Expansion Joint to First Guide	First to Second Guide	Maximum Distance Between Intermediate Guide (ft.) for Pressures (PSIG) Shown Below				
			50	100	150	200	250
3"	1'	3.5'	33'	24'	21'	19'	17'
4"	1.25'	4.75'	45'	33'	27'	25'	23'
5"	1.75'	5.75'	53'	41'	34'	31'	27'
6"	2'	7'	60'	43'	37'	33'	31'
8"	2.75'	9.25'	75'	56'	47'	43'	39'
10"	3.25'	11.75'	94'	70'	60'	53'	47'
12"	4'	14'	104'	77'	65'	57'	53'

Copper tube guide spacing

Tube Sheet	4 × D	14 × D	Maximum Spacing for Intermediate Guides for Copper Water Tube (ft.)		
			25 PSI	50 PSI	70 PSI
3/4"	3'	10 1/2"	7	6	5
1"	4'	1'2"	9	8	6
1 1/4"	5'	1' 5 1/2"	14	11	9
1 1/2"	6'	1' 9"	14	11	9
2"	8'	2' 4"	19	14	12
2 1/2"	10'	2' 11"	23	17	15
3"	1'	3' 6"	27	20	18
4"	1' 4"	4' 8"	31	23	21

Note: For type M tubing. For type "L" tubing, spacing may be increased by 10%. For type "K" tubing, spacing may be increased by 20%.

- Mount guide bracket to a firm, solid surface
- Do not exceed maximum service temperature of 270 °F (132 °C)
- In the system, pipe anchors (by others) should be located per the Expansion Joint Manufacturers Association (EJMA) Standards:
 - At the blind end of a pipe
 - At a change in direction of flow
 - Between two expansion joints of different sizes
 - At the entrance of a side ranch into the main line
 - Where a valve is installed in a pipe run between two expansion joints
- The anchor (by others) bracket must be mounted to a firm, solid surface.
- The copper anchor (by others) should be soldered to the copper tube for best results.